

# Products Feature&Application (12V 480Chips series)



No spot, no shadow, soft light

The emitting angle can reach to 180°

Interior lighting

Customized lighting design

Decorative light and Background

Architectural lighting

## Physical Dimensions

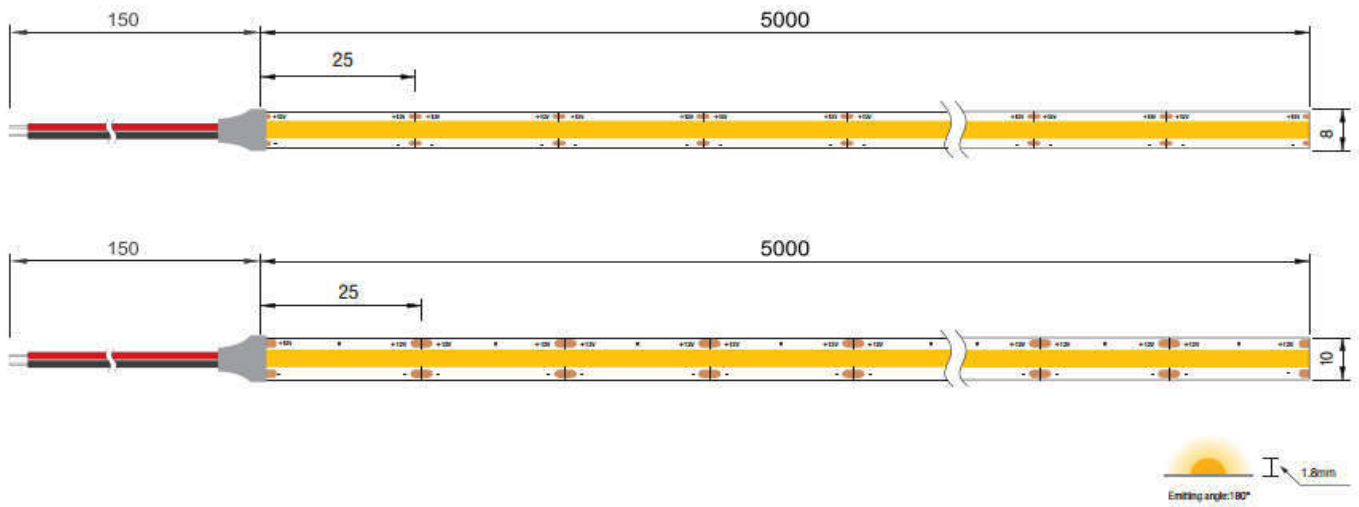

## Optical and Electrical Data

Chip type	COB
Product Life	>50,000Hrs
CRI	>90
Beam Angle	180°
Input Voltage	DC12V

Chip QTY	480leds/m			
CCT	2700k	3000K	4000K	6500K
PCB Width	8mm /10mm			
Cutable length	25mm			
Power Consumption	5w/m,10w/m,15w/m available			

## Lum Flux parameter

CCT	5W/m		10W/m		15W/m	
	Lumen (LM/m)	Efficacy (LM/w)	Lumen (LM/m)	Efficacy (LM/w)	Lumen (LM/m)	Efficacy (LM/w)
2700K±100K	482	96	957	96	1418	94
3000K±150K	519	104	1029	103	1527	102
4000K±250K	575	115	1138	114	1690	112
6500K±300K	560	112	1124	112	1672	111

# Waterproof solution and size

## Gel coating



IP65

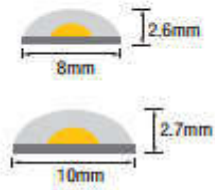

## Heat shrinkable tube



IP65

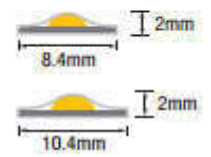

## Silicone tube



IP67

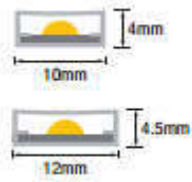
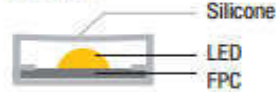

## Extrusion filling



IP68

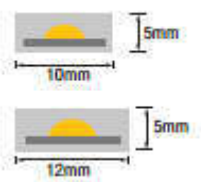
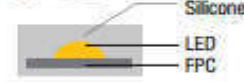

# Cautions

When install the led strip, please note the installation technique. The led strip can be bent, but not distorted, as shown below.

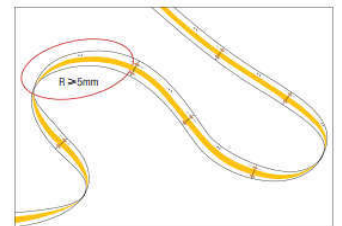
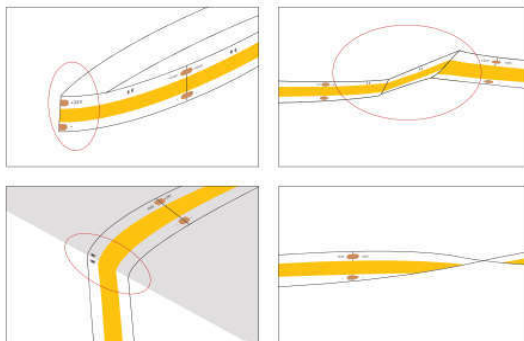
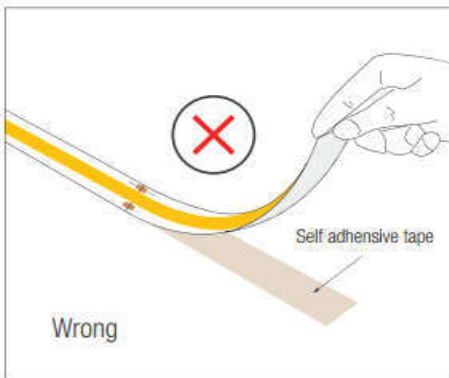

Distortion(Wrong)

Bend(Right)